

iClean® FLO₃

IMPORTANT SAFETY INSTRUCTIONS.
READ THESE INSTRUCTIONS COMPLETELY BEFORE USE.
SAVE THESE INSTRUCTIONS FOR FUTURE REFERENCE.

Applications & Model #s

| | | | |
|-------------------|------------------------|--------------------------|-------------------|
| Faucets (LQFC510) | Ice Machines (LQFC520) | Beverage Lines (LQFC530) | Laundry (LQFC540) |
|-------------------|------------------------|--------------------------|-------------------|

Included with Purchase

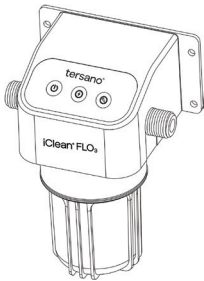
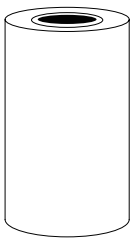
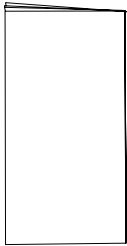
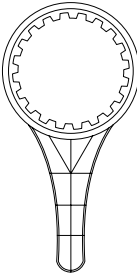
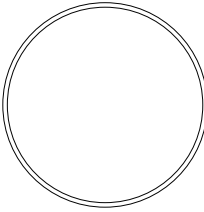
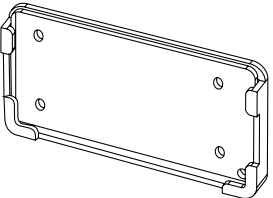
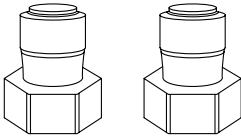
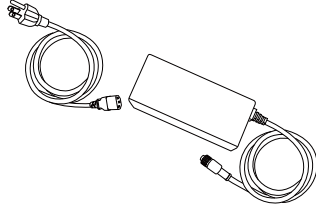
| | | | |
|--|---|---|---|
|  <p>iClean FLO₃</p> |  <p>Sediment Filter x1 (Inside Filter Housing)</p> |  <p>User Guide x1</p> |  <p>Filter Housing Wrench x1</p> |
|  <p>Spare Part For Future Replacement: O-Ring x1</p> |  <p>Mounting Bracket x1</p> |  <p>3/8" Push-fit Connector x2</p> |  <p>Power Adapter x1</p> |

Specifications

| | |
|-----------------------|---------------------------------|
| Model Number | LQFC5XX |
| EPA Establishment # | 93508-CHN-1 |
| Dimension | 131 x 104 x 175 mm |
| Net Weight | 530 g |
| Power Supply | AC 100-240 V, 50/60 Hz (100 W) |
| Water Line Connection | ½" BSPP threaded to ¾" push fit |
| Water Pressure | 0.02 MPa - 0.40 MPa |
| Flow Rate | 1.0 - 8.0 L/min |
| Ozone Concentration | 0.5 - 1.7 ppm |
| Tap Water Quality | Clean, TDS 60-200 ppm |
| Water Temperature | 4-40 °C |

Important Safeguards

- Read and follow this User Manual before installation, maintenance, and use. Failure to do so could result in injury, death, damage, and voided warranty.
- Tighten filter housing when in use.
- Disconnect electrical circuits before installing/servicing.
- Do not immerse power cord in water/liquid.
- Do not install device near burners, heaters, or cooking appliances.
- Install all plumbing connections before plugging power to power on.
- Never disassemble, repair, or customize the device; a certified technician must perform all repairs.
- Do not operate device if damaged/malfunctioning; unplug and call the manufacturer.
- Install over drain.
- Indoor use only.
- For more safety info, visit www.tersano.com.

Limited Warranty is valid for one year from the date of your purchase of the product as shown by the sales receipt. Details on website: www.tersano.com.

tersano® | For more information, contact tersano: (800).727.8835 • service@tersano.com

US and international patents pending.
SAO®, iClean®, and tersano® are registered trademarks of Tersano Inc.

iClean® FLO₃

Installation

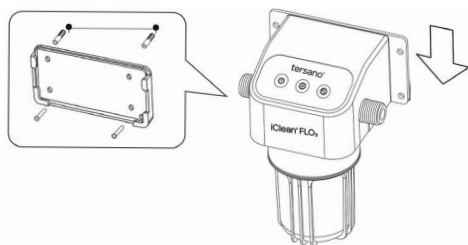

1

Drill holes on a wall/board for mounting bracket. Screw (not provided) bracket to the wall/board.

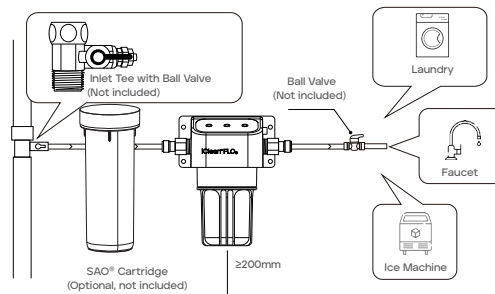

2

Connect water line connection to water source and device. If water line leaks, check position and re-install.

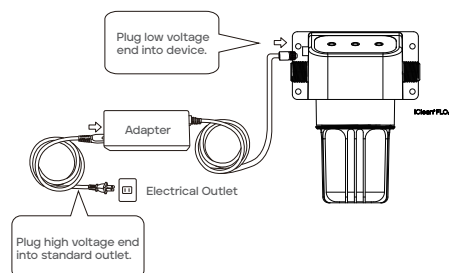

3

iClean FLO₃ is ready to use after water and electrical connection configured.

Indicator Status

Description

Power indicator (Green On)
Other lights off

Standby

Power indicator (Green On)
Working indicator (Blue On)
Maintenance indicator (Red Off)

Work normally

Power indicator (Green On)
Working indicator (Blue Flashing)
Maintenance indicator (Red on)

Machine fault or maintenance

Power indicator (Green Flashing)
Working indicator (Blue On)

Water inflow exceeds the maximum value of the machine (please reduce the water inflow)

Troubleshooting

| Indicator Light | Possible Cause | Solution |
|--|--|--|
| <ul style="list-style-type: none"> All indicator lights off Water outlet does not produce solution | <ul style="list-style-type: none"> Power is not connected Power adapter is faulty Equipment Failure | <ul style="list-style-type: none"> Check if power plug is loose Replace power adapter Call service |
| <ul style="list-style-type: none"> All indicator lights off Water outlet produces solution | <ul style="list-style-type: none"> Indicator light fault | <ul style="list-style-type: none"> Call service |
| <ul style="list-style-type: none"> No water from the water outlet | <ul style="list-style-type: none"> Outlet water flow is blocked No water supply to the inlet Blockage inside device | <ul style="list-style-type: none"> Replace sediment filter Ensure inlet pipe connected Ensure water source to inlet correct Call service |
| <ul style="list-style-type: none"> Power light on Operation light off Water flow is nominal | <ul style="list-style-type: none"> The flow meter does not work | <ul style="list-style-type: none"> Call Service |
| <ul style="list-style-type: none"> Blue light off | <ul style="list-style-type: none"> Flow rate too low | <ul style="list-style-type: none"> Increase flow rate to minimum of 1L/min |

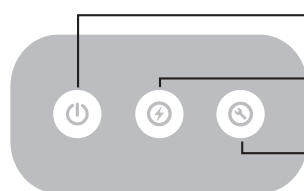

Continuous Green: Standby
Flashing Green Light: Water inflow exceeds maximum value of machine

Continuous Blue: Working

Continuous Red: Call Service

Replace sediment filter every 3-6 months (average). Refer to instructions in replacement sediment filter package.

tersano® | For more information, contact tersano: (800).727.8835 • service@tersano.com

US and international patents pending.
SAO®, iClean®, and tersano® are registered trademarks of Tersano Inc.